

## WATER-PROOF AND LOWER POWER CONSUMPTION WIFI BATTERY CAMERA

### Quick Guide

\* Before using the product, please read the Quick Guide carefully and keep it well.

### Packing List

After opening the package, please check the door bell (the "Equipment") to verify whether the following parts are complete.

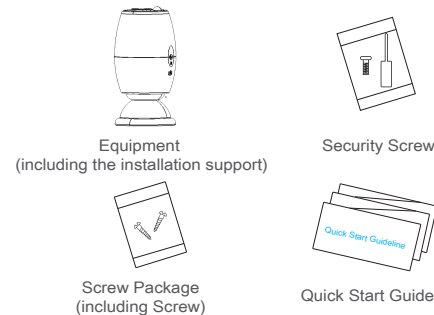

### Appearance

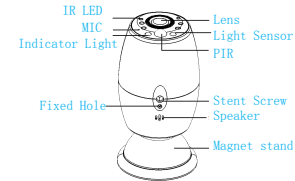

- IR LED** In the event of inadequate ambient light, turn on the IR LED to increase the brightness.
- Light Sensor** Used to collect ambient light. When luminance is lower than 2 Lux, turn on the IR LED
- MIC** Used to collect ambient sound and achieve vocal dialogue
- PIR** When someone moves in front of the equipment, triggers a signal that is generated and sent to the cell phone
- Lens Indicator Lights** Used to collect the image and video  
When the Blue Indicator Light is blinking, the Equipment is in the configuration status;  
When the Red Indicator Light is always ON, the WiFi connection has failed;  
When the Blue Indicator Light is always ON, the Equipment is successfully connected;  
When the Red and Blue Indicator Lights are ON at the same time, the Equipment is connected to WiFi;  
When the Red and Blue Indicator Lights are OFF at the same time, the Equipment is OFF or standby;

- Speaker** Used to send out a system prompting sound and achieve vocal dialogue
- Stent Screw Fixed Hole** For vertical stand (optional)  
Use the mounting screws included in the accessory kit to fix the rear stand
- Magnet Stand** To fix the camera

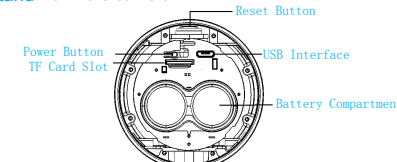

- Power Button** Short press 1 second to boot, blue light will turn on; Press and hold for 3 seconds to shut off, you can hear the horn sound; In sleep mode, press briefly for 1 second to wake up the device; Under the blue light working condition, short press 1 second to push message.
- USB Interface** The battery of the equipment is charged through the USB interface, When connected USB the equipment will be automatically turned on
- Reset Button** When the Equipment is working, press this button for 5 seconds to reset to the default settings
- Battery Compartment** You can install two 18650 batteries (please note the positive and negative direction, the negative electrode is facing outward), You do not have to connect connect the equipment to the wire power, installing the battery will turn on the equipment automatically
- TF Card Slot** The user can insert 8G, 16G, 32G SD card (Please use branded card with C10 and above) to store video image files

### Installation Guide

As shown in the figure, install the stand

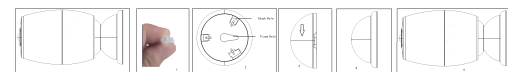

- Use the mounting screws inside the kit to mount the rear stand on the wall, and then twist the magnet stand on it according to the direction of the arrow. (Or use 3M glue to stick in on tempered glass or stainless steel)
- Twist the back shell in the direction of the arrow

- Twist the battery cover in the direction of OPEN and install two 18650 batteries (it can work with 1 battery alone, too, Please pay attention to the positive and negative poles of the battery, the negative electrode is facing outward). Put the battery cover back and twist it toward the direction of CLOSE
- Press and hold the Power button for 3 seconds to turn it on/off; press and hold the Reset button for 5 seconds and wait for the red indicator to flash slowly to enter the phone APP connection mode
- After opening the mobile phone APP and connecting it to the equipment successfully, fasten the USB rubber stopper and twist the back shell in the direction of the arrow
- Use the backshell screws in the kit to mount the rear stand, align the equipment to the magnet stand, and adjust it to a suitable location to complete the installation

### Equipment Connection

Thanks for choosing our product. To start with, scan the following QR codes to install the app. After completion, set up your Equipment by following the steps below

#### 1. Download the Mobile App



- Scan the QR codes to download it
- For Apple users, search "XSH cam" in the App Store to download it
- For Android users, search "XSH cam" in Google Play to download the app

#### 2. Setting up New Equipment

Power on the Equipment and wait for the system voice prompting: "Enter the Configuration Status". (If not in this status, please press and hold the Reset Button for 5 seconds after waking up the Equipment, and release it after the Equipment's LED is OFF. The system is automatically restarted.) After the Equipment enters the configuration status, please ensure that the cell phone is connected to the available WiFi. After that, open the XSH cam app to install the doorbell lens

#### Click to add the Equipment

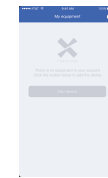

Before setting, ensure that the Equipment is in the configuration status. Under the configuration status, there will be a voice prompt to "enter the configuration status"



The app will automatically complete the name of the WiFi. Please input the corresponding WiFi password, turn up the volume, and then click "Next". If this is the second time you are connecting to the same WiFi, the app will automatically complete the password. It is not necessary to re-enter the password

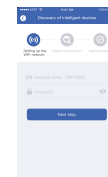

#### Click to install the lens



If no prompting voice is heard, please press the Reset Button for 5 seconds and wait until the LED is OFF, and then release it. The Equipment will be restarted to enter the configuration status



The cell phone will send out a sound wave. Please keep quiet at this moment. Please put the cell phone 30cm away from the Equipment, and wait for the Equipment to configure the network



The Equipment has been connected with the network. Please enter the name and password of the Equipment. The password must be at least 8 characters long (including upper case letters, lowercase letters and digits) (the password listed is for reference only)

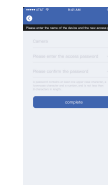

#### 3. Instructions on Use of Equipment

1) In the List of Equipment interface, click the Setting icon at the upper-right corner of the Equipment to enter the setting interface of the Equipment

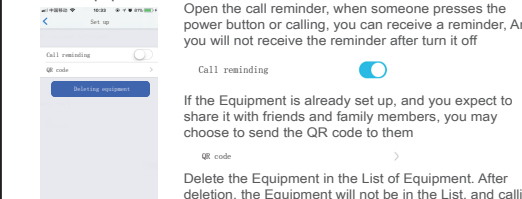

Open the call reminder, when someone presses the power button or calling, you can receive a reminder, And you will not receive the reminder after turn it off

If the Equipment is already set up, and you expect to share it with friends and family members, you may choose to send the QR code to them

Delete the Equipment in the List of Equipment. After deletion, the Equipment will not be in the List, and calling will not be received any more, but the lens will not be affected. The Equipment can still be checked by other connected cell phones

#### Instructions on PIR

The PIR function is supported. To activate it, just choose PIR in the setting menu

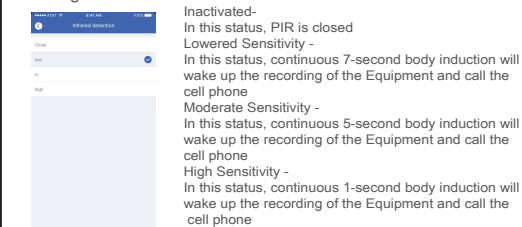

Inactivated- In this status, PIR is closed  
Lowered Sensitivity - In this status, continuous 7-second body induction will wake up the recording of the Equipment and call the cell phone  
Moderate Sensitivity - In this status, continuous 5-second body induction will wake up the recording of the Equipment and call the cell phone  
High Sensitivity - In this status, continuous 1-second body induction will wake up the recording of the Equipment and call the cell phone

The setting is done. The Equipment will automatically enter the List of Equipment interface. Congratulations! The Equipment has been successfully installed

**Note: If used in a higher traffic environment, OFF or Lowered Sensitivity is suggested in order to reduce the waking up of the Equipment and call times, thus prolonging the battery life**

#### 4. Attention!

- The Equipment uses a polymer battery. When charged full, it is estimated to last 6 months. When it is running out of power, the cell phone app will prompt you. Please recharge the Equipment in a timely manner after receiving the prompt
- During installation, please ensure that the network is normal in the installation environment, and especially outdoors, please check whether WiFi covers the area. In the case of a weak WiFi signal, it is required to add a WiFi signal relay amplifier
- This device is a low-power consumption smart product that can support APP remote wake-up, PIR human detection wake-up and press the power button to wake up. Every 15 seconds after awaken it will automatically go to sleep mode until the next wake up

### Technical Parameters

Resolution	1280* 720
Field of Angle View	166° (opposite angle)
IP53 (rainproof)	6 lights, 850mm
Wi-Fi	802.11b/g/n supported
Audio	Two-way speaking, with echo removal function
Recording	TF Card (15 seconds/time)
Storage	8G/16G/32G
Battery	two 18650 batteries, 6800mAh
Push	Quick push for 2 seconds to wake up for 600ms
Prompting	Press/PIR/cell phone positive waking up
power	Standby current 120uA/working current 170uA
Water-proof Level	IP54 (rainproof)

**Tip: If working 10 minutes per day, two 18650 batteries (6800mAh) can be used for 6 months**

### Q&A

- Q: Why can't the Equipment be connected to WIFI?  
A: 1. Please confirm that the WiFi connection is under the 2.4G protocol.  
2. Confirm that the Red Indicator Light is blinking slowly.  
3. Check whether the account name and password are correct, and whether there are excessive spaces.
- Q: The Equipment is online, and there is a trigger event, but the cell phone does not receive any push messages  
A: Check whether the app has "automatic starting" activated, and whether the "application authority" has the notification function activated.  
Disable "battery optimization" and "close the app when in the background and Always On Display" (depending upon the actual situations, considering different optimization modes for different cell phone manufacturers)
- Q: What kinds of power supply modes are supported?  
A: 1. Equipment can work with 18650 battery alone  
2. Can charge the device via USB, When connected with USB it will be turned on
- Q: Does the Equipment support 3G?  
A: 3G cell phones are not supported, only 4G is supported

### Introduction to Functions

- Two 18650 batteries (6800mAh) can be used for 6 months
- A million HD pixels matched with a 1.7MM wide-angle lens
- Cell phone waking up supported
- 2.4G WiFi connection supported
- Clear two-way speaking
- PIR supported. When someone is wandering outdoors, warning information is immediately pushed to the cell phone app
- Automatic switching of Day/Night mode, all with clear pictures, safeguarding you and your family members

**Tip: There will be no further notification of any change of the above functions. Please take the actual object as the standard. Thanks!**